



MEETING OF THE BOARD OF DIRECTORS  
Greater Los Angeles Education Foundation  
Wednesday, October 30, 2024, at 2:00 PM – 4:00 PM  
9300 Imperial Highway, EC 100, Downey, California 90242

AGENDA

- |                          |   |
|--------------------------|---|
| <i>Dr. Monte Perez</i>   | <b>1. Call to Order</b>   |
| <i>Dr. Monte Perez</i>   | <b>2. Approval of the Agenda</b>  |
| <i>Dr. Monte Perez</i>   | <b>3. Public Comments</b>   |
| <i>Dr. Monte Perez</i>   | <b>4. Review and Approval of Minutes</b> <ul style="list-style-type: none"><li>a. July 9, 2024 (Attachment A)</li></ul>   |
| <i>Ms. Kerry Franco</i>  | <b>5. Ad hoc Committee Reports</b> <ul style="list-style-type: none"><li>a. Board Recruitment<ul style="list-style-type: none"><li>i. Nomination of New Board Member (Attachment B)</li></ul></li><li>b. Compensation</li></ul>   |
| <i>Ms. Kerry Franco</i>  | <b>6. President's Report (Attachment C)</b>   |
| <i>Ms. Gloria Rogers</i> | <b>7. Business and Finance</b> <ul style="list-style-type: none"><li>a. Review Statement of Financial Position (Attachment D)</li><li>b. Review Budget vs. Actuals (Attachment E)</li><li>c. Review Projected Cash Flow (Attachment F)</li><li>d. Review Fiscal Sponsored Projects (Attachment G)</li></ul> |
| <i>Dr. Monte Perez</i>   | <b>8. Consent Agenda</b> <ul style="list-style-type: none"><li>a. Acceptance of Funds (Attachment H)</li><li>b. IYEF Endowment Statement of Activity (Attachment I)</li><li>c. IYEF Grant Recommendations (Attachment J)</li></ul>  |
| <i>Mr. Sam Gelinas</i>   | <b>9. GLAEF Program Updates (Attachment K)</b>  |
| <i>Dr. Monte Perez</i>   | <b>10. Other Business</b> <ul style="list-style-type: none"><li>a. LACOE Updates</li><li>b. Board Member Updates</li></ul>  |
| <i>Dr. Debra Duardo</i>  |   |
| <i>Dr. Monte Perez</i>   | <b>11. Board Meeting Calendar</b> <ul style="list-style-type: none"><li>a. Review 2024-2025 Board of Directors Meeting Calendar (Attachment L)</li></ul>  |
| <i>Dr. Monte Perez</i>   | <b>12. Adjournment</b>  |

The full agenda is accessible through the receptionist at the northeast entrance of the above address. Enclosures to the agenda are available for review in the Greater LA Education Foundation office during business hours 8:30 a.m. – 5:00 p.m. Any material related to an item on this Board Agenda distributed to the Greater LA Education Foundation Board of Directors is available for public inspection at Greater LA Education Foundation's office at 9300 Imperial Highway, Downey. Procedures for addressing the Board are available in the Board meeting room and posted on the Greater LA website. To request a disability-related accommodation under the ADA, please contact Kristina Romero at [kromero@greaterlaedfund.org](mailto:kromero@greaterlaedfund.org) least 24 hours in advance.



**UNAPPROVED MINUTES**  
**MEETING OF THE BOARD OF DIRECTORS**  
 Greater Los Angeles Education Foundation

Thursday, July 9, 2024

An annual meeting of the Board of Directors of the Greater Los Angeles Education Foundation (GLAEF) was held on Thursday, July 9, 2024, at the Los Angeles County Office of Education Board Room.

Present: Dr. Monte Perez, Dr. Debra Duardo, Mr. David Sanford, Ms. Elizabeth Graswich, Ms. Andrea Foggy-Paxton, Ms. Gloria Rogers, Mr. Gary Newman, Mr. Chris Steinhauser

Others Present: Ms. Kerry Franco, Ms. Alexandra Roosa, Mr. Sam Gelin. Ms. Kristina Romero

**CALL TO ORDER**

Dr. Monte Perez called the meeting to order at 10:32 a.m.

**APPROVAL OF THE AGENDA**

Dr. Perez reported that there were no changes to the Board agenda.

It was MOVED by Ms. Graswich, SECONDED by Mr. Sanford. All approved; none opposed.

**PUBLIC COMMENTS**

NONE

**APPROVAL OF MINUTES**

February 29, 2024 minutes were approved as presented.

It was MOVED by Ms. Foggy-Paxton, SECONDED by Ms. Graswich, and CARRIED to approve the February 29, 2024 minutes as presented. All in favor; none opposed.

Mr. Sanford requested a takeaways from the board retreat in February.

**BOARD OF DIRECTORS MEMBER ELECTIONS**

Dr. Perez shared that Ms. Rogers' two-year term as board members had expired and asked for a motion to renew Ms. Rogers' for a full term as a member of the Board of Directors.

It was MOVED by Mr. Steinhauser, SECONDED by Mr. Sanford, and CARRIED to renew Ms. Rogers' term as a member of the Board of Directors. All in favor; none opposed.



Dr. Perez shared that Mr. Newman had accepted his nomination to join the Board of Directors and asked for motion to approve Mr. Newman as a new member of the Greater Los Angeles Education Foundation Board of Directors.

It was MOVED by Mr. Sanford, SECONDED by Mr. Steinhauser, and CARRIED to approve Mr. Newman as a member of the Board of Directors. All approved; none opposed.

## **FINANCE**

Ms. Rogers provided the following finance update:

- Statement of Financial Position:
  - GLAEF's total assets increased by \$12.8M, largely due to a \$12.75M endowment from Murphy's Bowl, LLC. Other notable contributions included \$500K from Goldman Sachs (Ballmer) and various other donations.
  - Significant transfers to new Schwab investment accounts occurred, resulting in decreased California Credit Union balances.
  - Received reimbursement from LACOE for Los Angeles County Impact Hubs work, with additional outstanding invoices. A credit of \$80K from LACOE is pending.
  - Liabilities decreased by \$304K due to a \$186K grant payable to LACOE and accrued expense adjustments.
  - The donor-restricted net assets increased by \$12.75M.
  - GLAEF reported a net surplus of \$14.7M for Q3.
- Budget vs. Actual:
  - Revenue ended Q2 with a \$13.9M favorable variance, mainly from the unanticipated Murphy's Bowl endowment.
  - Expenses finished with a favorable variance of \$747K, with notable savings in grant disbursements, event sponsorships, professional services, and conferences due to timing shifts.
- Projected Cash Flow & FY25 Budget:
  - Q4 cash balance projected to be \$18.8M. Plans to spend down grant funds received in FY23.
  - Consistent with FY24; the FY25 budget includes a projected revenue of \$3.9M and a 3.2% staff cost-of-living adjustment. Major expenditures include continued support for LACOE initiatives and new grant allocations.

Dr. Perez request a motion to approve the Acceptance of Funds for the period of July 1, 2023 through March 31, 2024.

It was MOVED by Dr. Duardo, SECONDED by Mr. Sanford, and CARRIED to approve the acceptance of funds. All in favor; none opposed.

## **AUDIT COMMITTEE REPORT**



Ms. Roosa provided the following audit committee update:

The FY23 audit for GLAEF, conducted by Quigley & Miron, resulted in a clean, unqualified opinion. This indicates that the auditors found GLAEF's financial statements to fairly and accurately represent the organization's financial position in compliance with Generally Accepted Accounting Principles (GAAP). The audit did not reveal any material deficiencies, weaknesses, or noncompliance in GLAEF's internal controls, financial transactions, reporting, or regulatory adherence.

Key Highlights:

- Quigley & Miron conducted a detailed analysis of GLAEF's financial statements, internal controls, and compliance protocols. This included verifying revenue sources, expenses, restricted funds, and grant agreements.
- The audit identified no significant issues in financial practices, signaling a robust internal control environment and effective compliance with applicable laws and regulations.
- The auditors' independent assessment confirmed that GLAEF's financial statements fairly present the organization's position, providing confidence to stakeholders regarding financial stewardship.

The FY23 audit reflects GLAEF's commitment to transparent and responsible financial practices, serving as a strong foundation for continued fiscal accountability.

## **PRESIDENT'S REPORT**

Ms. Franco expressed gratitude to board members for their ongoing commitment to GLAEF, highlighting the significant progress made and the positive impact of everyone's collaborative efforts. A warm welcome was extended to new board member Mr. Gary Newman, with the President emphasizing the organization's dedication to serving the community and improving educational opportunities through partnerships with LACOE and other key stakeholders.

Ms. Franco provided the following key updates:

- **Marketing and Communications:**
  - The newly refreshed website is set to launch publicly next week, coinciding with the press release for the Inglewood Youth Education Fund. The release has received approval from the donor and is pending final clearance from the City of Inglewood.
  - A new foundation email domain will be introduced and contact information on the website will be updated accordingly. These updates are expected to streamline communications as the organization prepares for year-end giving campaigns.
- **Fiscal Sponsorship Program:**



- Ms. Franco introduced a proposed resolution to allow foundation staff to approve fiscally sponsored projects up to 10% of the annual budget independently. Projects exceeding this threshold would require board approval. This initiative aims to support school districts in establishing funds for specific projects, with the foundation providing administrative and financial oversight. A maximum administrative fee of 10% is recommended to ensure proper insurance coverage and operational support for these projects.
- Discussions included ensuring transparency and monitoring for fiscally sponsored districts on watch lists, with the foundation committed to maintaining oversight and compliance.
- Year-End Giving and Engagement:
  - Plans are underway to enhance year-end giving initiatives, leveraging the updated website and new marketing strategies. The President noted the importance of engaging with the community to raise awareness and support for GLAEF's programs, particularly the Inglewood Youth Education Fund.

Ms. Franco concluded by reiterating the organization's commitment to fiscal responsibility, effective governance, and continued growth in service of its mission.

Dr. Perez asked for a motion to adopt the resolution to approve the process for fiscally sponsored projects.

It was MOVED by Mr. Steinhauser, SECONDED by Ms. Foggy-Paxton, and CARRIED to approve the process for fiscally sponsor projects. All in favor; none opposed.

Ms. Franco continued with the following updates on the board's strategic planning and engagement efforts, focused on fostering meaningful connections with current and future board members to support GLAEF's long-term goals:

- Board Demographics and Recruitment:
  - Recent assessments of board demographics and insights from the February retreat have informed a new recruitment strategy, aiming to diversify and align the board with LA County's student population. With one vacancy left, the recruitment process will prioritize expertise in fundraising and nonprofit development and lay the groundwork for future planning.
- Board Engagement Plan:
  - A new engagement plan is in development to foster two-way interaction between board members and GLAEF staff, enhancing board members' involvement in programmatic work. An ad hoc recruitment committee is proposed to work alongside the governance committee to fill the vacancy,



with potential exploration of expanding the board to include student or parent representatives.

- Future Goals and Alignment with Mission:
  - Ms. Franco outlined a vision for creating a “live document” that tracks board retreat outcomes, key discussion points, and progress toward GLAEF’s mission over the year, serving as a guide for ongoing alignment with GLAEF’s priorities and programming.

Dr. Duardo highlighted the need for documenting retreat outcomes with actionable next steps, timelines, and measurable goals. This approach would allow the board to track progress on strategic initiatives, ensuring accountability and evaluating achievements against set targets.

Dr. Perez asked for a motion to establish an ad hoc board recruitment committee.

It was MOVED by Mr. Sanford, SECONDED by Ms. Rogers, and CARRIED to approve the establishment of an ad hoc board recruitment committee.

## **OTHER BUSINESS**

Mr. Gelinas provided a program update and introduced Stitch, a new platform designed to provide a comprehensive list of out-of-school learning opportunities for students. Stitch offers two views: one for educators and one for families, featuring over 400 organizations and 700 programs across LA County. Key partners, such as the Getty, contribute to the platform, which includes museum programs linked to the PST Art Exhibit Series. Stitch aims to be an interactive map with detailed program information, resources, and integration options for classroom use. Additionally, the platform will incorporate data visualization features to identify areas where additional educational resources are needed.

Dr. Duardo shared an update on new programs being implemented at juvenile court schools. These programs include an entrepreneurship initiative where students identify their strengths and develop business plans for post-incarceration life, as well as a drumline program introducing music and teamwork to young students. Additional activities involve art and creativity classes led by LACHSA artists and physical education provided by an Inglewood P.E. coach.

Dr. Duardo highlighted challenges faced in expanding access, particularly for students who have already graduated but lack meaningful activities. Efforts are underway to collaborate with probation officials to allow these youth to participate in the programs. Dr. Duardo expressed appreciation for the positive impact these initiatives have had,



observing high engagement and enthusiasm among students. A social-emotional camp will follow, focusing on healing and addressing underlying issues.

### **ADJOURN TO CLOSED SESSION**

The board entered a closed session to discuss the 2024 Compensation Study and Staffing.

Dr. Perez asked for a motion to enter a closed session. It was **MOVED** to enter a closed session by Mr. Steinhauser; **SECONDED** by Dr. Duardo. All in favor; none opposed.

### **RECONVENE IN OPEN SESSION**

The board reconvened in open session. The board approved the formation of an ad hoc compensation committee.

### **APPROVAL OF FISCAL YEAR 2025 BUDGET**

Dr. Perez ask for a motion to approve the FY25 budget.

It was **MOVED** to approve the FY25 budget as presented with the amendment discussed in closed session by Mr. Steinhauser; **SECONDED** by Ms. Rogers. All in favor; none opposed.

### **BOARD MEETING CALENDAR**

Dr. Perez asked for a motion to approve the FY25 regular board meeting calendar.

It was **MOVED** to approve the FY25 Board of Directors Regular Meeting Calendar by Ms. Graswich; **SECONDED** by Ms. Rogers. All in favor; none opposed.

### **ADJOURNMENT**

It was **MOVED** to adjourn at 12:47 p.m. by Mr. Steinhauser; **SECONDED** by Dr. Duardo. All in favor; none opposed.

# Iris Zuñiga

**Email:** iris@amanecerconsulting.com **Cell Phone:** (818) 335-8969

## OVERVIEW

- Nonprofit, public-sector executive with 20 years of experience across public administration, program development, operations, fundraising, coalition building, and results-driven place-based work.
- Public/private partnership expert with a demonstrated history of working in social services and education field that has shown impact and increased academic proficiency and college admittance rates at LAUSD, Pilot, and Charter Schools in the Promise Neighborhood and Promise Zone.
- Annie E. Casey Fellow (2019-2021).
- Spearheaded Promise Neighborhood Community Schools Initiative and the Promise Zone Designation, which resulted in a 340-million-dollar investment from the federal government within five years.
- Experience as a City of Los Angeles commissioner and nonprofit board member.
- Thrive in environments at the intersection of social justice, education, and social services and lead the way in cross-sector partnerships.
- Bilingual – Fluent in both English and Spanish.

## EXPERIENCE

### **Amanecer Consulting Group, Los Angeles — Co-founding Partner**

2020-Current

- Provide strategic counsel to non-profit and government agencies on participant engagement and community activation.
- Coach Executive leaders towards moving from talk to action and implementing systems that support results and impact at a large scale.
- Facilitate program design and flow of services for direct service providers, from beginning to end, identifying systems and processes needed to provide quality services.
- Fund Development, leveraging existing funding and growing investments with private and government dollars to maximize community footprint.
- Created coalition infrastructure using a collective impact model and place-based strategies to align policy and direct services and create investment opportunities.

### **The Wonderful Company, Santa Monica — Executive Director, College Success**

2020-2021

- Executed a comprehensive strategic plan to significantly increase college preparation and college persistence of predominantly first-generation college-bound students in the Central Valley.
- Created, managed, and assessed investments designed to dramatically improve college readiness, persistence, and completion rates.
- Improved and maintained the team's systems to track and analyze student and program performance and progress toward goals.
- Monitored student academic progress with college and university partners throughout the year, closely monitoring problem-solving and creative approaches to resolve student learning and student success challenges quickly.
- Developed and oversaw a sequence of college support events, experiences, and workshops for college students and their parents to motivate them to set and achieve extraordinary academic, career, and life goals.
- Oversaw family engagement and family and parent education efforts to forge a robust student-family partnership that supported each student to and through college.
- Initiated GEAR UP collaborative that resulted in an 8.7-million-dollar investment from the federal government to provide academic and college support services to 1,500 scholars over seven years.



## **Youth Policy Institute, Los Angeles — Executive Vice President 2017-2019**

COO December 2009 to 2017

- Played a key leadership role in a \$50 million nonprofit organization dedicated to education and social services, with a mission to lift families out of poverty. The organization experienced tenfold growth by prioritizing public-private partnerships and fostering effective cross-collaboration.
- Provided direct oversight and leadership of the executive team: COO, CDO, Chief Academic Officer, Chief Community Development Officer, Director of Communication, and Director of Research and Evaluation (7 direct reports, 500 full-time staff, and 1000 part-time staff).
- Led the strategic planning process, both planning and implementation, and implemented the core service delivery model across the agency, focusing on the Participant Centered Framework and service integration across critical community centers and school sites (100,000 participants served a year).
- Developed systematic refinement of the Cradle to College and Career pipeline investment strategy (50-million-dollar budget, 92% government-funded / 8% privately funded) targeted 26 core schools (District & Charter)
- Provided strategic growth by analyzing data and identifying high-need areas where a cradle-to-college and career, the strategy would be impactful.
- Provided oversight of 137 school sites (charter, pilot, and district) and community centers throughout the City of Los Angeles, 5 of them being the City of Los Angeles-funded service centers: Family Source Center (2,500+ participants), Work Source Center (1,300+ participants) and two Youth Source Centers (800+ participants).
- Provided strategic direction and support for the organization's White House Neighborhood Revitalization Initiatives and Place-Based Strategies (CHOICE, BYRNE, Promise Zone, and Promise Neighborhood).
- Worked collaboratively with key internal and external stakeholders in the Promise Zone (60 partners) and identified community needs and assets, develop goals and outcomes that lead to the reduction of poverty (340-million-dollar government investment in 5 years ~Promise Zone).
- Redefined the organization's development and fundraising goals by meeting with existing and potential funders; braiding government and private funds to leverage and support transformative initiatives.
- Championed board development by growing the board of directors and investing the necessary time and resources to develop the support base. The board grew from five members to thirteen within two years.
- Lead conversations with funders, community leaders, and key stakeholders to build support and strengthen collective impact in targeted communities.

## **Youth Policy Institute, Pacoima / Los Angeles — Director of Youth Services**

2006 - November 2009

- Scaled the after-school department at YPI from 4 sites to 56 after-school programs across the city within three years.
- Responsible for tracking measurable outcomes for each contract, from attendance to performance.
- Created a culture of accountability, exceeded targets, and achieved +85% attendance at 95% of sites.
- Supervised 20 full-time and 300 part-time staff (indirectly). Including goal setting, site visits, and yearly performance reviews.
- Discovered an underserved employee pool of recent local grads and activated a marketing campaign to recruit them which resulted in 50% better retention than the organization had seen.
- Increased partnerships and collegial relationships with other non-profit organizations, coalitions, businesses, civic and political groups, and educational institutions. Partnerships doubled in the first year and continued to grow.
- Developed and oversaw curriculum development and implementation plan for the after-school programs; strongly emphasized creating a college-going culture, i.e., college panels, college field trips, A-G workshop series, and the four higher education systems.
- Worked with the Director of Development in submitting grants/renewals and provided information to qualify for additional program funding to continue expanding the number of sites, including building a solid outreach strategy to identify potential new areas and leaders within the field of education.

## **State Senate, Van Nuys — District Education Representative**

2005 - September 2006

- Created the Valley Education Collaborative, composed of 40 organizations targeting five high-need high schools in the Northeast San Fernando Valley.
- Implemented the “Got College!” program to increase the number of students admitted to a four-year college, coordinated classroom visits to 40 schools and a joint fall conference for 600 participants featuring parent and student workshops.
- Implemented SAT enrollment campaign targeting over 3,000 students.
- Statewide policy work on creating a master plan to end poverty focusing on education and job training.
- Assisted in research and information gathering relative to federal and state legislation related to education and anti-poverty strategies.

## PROJECTS / BOARDS

### **Annie E. Casey Fellowship — *Fellow***

2019 - 2021

One of 15 fellows selected nationally to work towards systematic alignment of social services across public sector agencies to ensure youth ages 14-24 have the necessary connections to school, work, and family to achieve equitable success outcomes, trained in Results-Based Facilitation and Results-Based Accountability Framework.

### **CA Lifting Children and Families out of Poverty Taskforce — *Sub-Committee Chair of Coordinated Services***

2018 to 2019

One of 40 task force members was selected statewide. The task force was created by Assembly Bill 1520. The lead convener was the CA Department of Social Services. It was intended to be a high-level policy plan to inform the new Governor and his administration of ways to strengthen the social safety net for children living in deep poverty.

### **Kresge - Human Services Program — *Lead Team Member***

2017 to 2019

One of 13 non-profit organizations selected nationally to develop a community of practice; creating organizational plans designed to advance and accelerate social and economic mobility using a two-generation, whole-family approach. Chosen as the lead for YPI, I was responsible for leading the development and implementation of the social services plan.

### **City of Los Angeles Recreation and Parks Commission — *Board Member / Vice President of the Board***

2014-2016

One of 5 Commissioners appointed by the Mayor of LA. 165,000,000-dollar department budget, 446 parks, 184 recreation centers. Supported the General Manager with identifying budget priorities that would later align with the Department’s Strategic Plan. Led the Concessions Taskforce during the RFP process for the Greek Theatre, a multimillion-dollar project—approved policies and execution of contracts and agreements and property acquisition.

### **Hispanas Organized for Political Equality (HOPE) — *HLI 2011 to Present***

## EDUCATION

**Loyola Marymount University, Los Angeles — *Doctorate in Educational Leadership for Social Justice – (Graduation 2024)***

**California State University, Northridge — *Masters in Public Administration***

**University of California, Los Angeles — *B.A. Sociology and Chicano/a Studies***

**Los Angeles Mission College, Sylmar — *Associates Degree / IGETC Completion***

## Board Member Candidate Nomination Intake Form

Dr. Iris Zuniga

**Occupation:** Co-founder Amanecer Consulting

### **Why are you interested in serving on the Greater Los Angeles Education Foundation Board of Directors?**

I am deeply committed to advancing educational equity and access for all students, particularly those from underserved communities. The Greater Los Angeles Education Foundation plays a pivotal role in shaping the future of education in our region, and I believe my experience in youth, family, and community development can contribute to its mission.

Serving on the board would allow me to leverage my expertise in strategic planning, community engagement, and educational initiatives to support the Foundation's goals. I am particularly passionate about fostering partnerships that drive systemic change, and I see an opportunity to help create sustainable pathways for student success across Los Angeles County.

Being part of the board would not only align with my professional values but also enable me to contribute to a cause that I am personally invested in – ensuring that every student has the opportunity to reach their full potential.

### **Tell us about your interest in and passion for improving public education in Los Angeles?**

Public education in Los Angeles has always been close to my heart, not just as a professional focus but as a personal commitment. Growing up, I witnessed firsthand the disparities in educational opportunities and resources within our communities. This fueled my desire to contribute to a system where every student, regardless of their background, has access to quality education.

Over the years, I've worked on various initiatives aimed at closing these gaps, from supporting community schools to developing programs that address both academic and socio-emotional needs. I'm particularly passionate about creating environments where students feel supported, valued, and empowered to succeed.

Improving public education in Los Angeles is about more than just policy—it's about fostering a culture of equity, innovation, and collaboration. I'm dedicated to working with others who share this vision to ensure that every child in our city has the opportunity to thrive.

### **Have you previously served on a nonprofit Board of Directors? If so, please describe your level of engagement and, if any, leadership roles you assumed.**

Yes, I have previously served on nonprofit Boards of Directors and held various leadership roles that have deepened my commitment to public service and community development.

From 2014 to 2016, I served as a Board Member and Vice President of the Board for the City of Los Angeles Recreation and Parks Commission. In this role, I was one of five Commissioners appointed by the Mayor of LA, overseeing a department with a \$165 million budget, 446 parks, and 184 recreation centers. I supported the General Manager in identifying budget priorities that aligned with the Department's Strategic Plan and led the Concessions Taskforce during the RFP process for the Greek Theatre, a multi-million-dollar project. My responsibilities included approving policies, executing contracts and agreements, and managing property acquisition.

In addition to this, I was the Sub-Committee Chair of Coordinated Services for the CA Lifting Children and Families out of Poverty Taskforce from 2018 to 2019. This task force, created by Assembly Bill 1520 and led by the CA Department of Social Services, was a high-level policy initiative aimed at informing the new Governor and his administration on ways to strengthen the social safety net for children living in deep poverty. I was one of 40 members selected statewide, and my role involved leading efforts to coordinate services across various agencies.

From 2017 to 2019, I also served as a Lead Team Member for the Kresge Human Services Program, where I was one of 13 nonprofit organizations selected nationally to develop a community of practice focused on advancing social and economic mobility using a two-generation, whole-family approach.

These experiences have allowed me to actively contribute to the governance and strategic direction of these organizations, always with a focus on creating lasting impact in communities.

**Geography:** San Fernando Valley

**How did you learn about this opportunity?**

Referral by Dr. Daisy Esqueda and Linked-In

**Please upload a copy of your most current resume and/or bio.**

<https://drive.google.com/open?id=18KgBnCYpQ7oBG5UbJvWiu2IZp9MAJGXN>



President's Report  
October 30, 2024

- **Changes to our meeting agenda format:** GLAEF staff appreciate the Board's feedback and strong interest in hearing more about our programs and initiatives at the Foundation. In response to this request, we are pleased to introduce slight changes to our agenda format. Our goal was to streamline the Board's operations, allowing us to maximize our time together for meaningful engagement in the Foundation's programmatic work.
- **Board Engagement Plans:** Since July, I have successfully met with each board member to outline engagement plans for the 2024-2025 year.
  - During these meetings, we discussed members commitment to support the foundation by participating in events and championing programs and initiatives. Additionally, members pledged personal gifts or commitment to fundraising efforts.
  - Board members were asked to sign engagement plans and conflict of interest forms, formalizing their commitment by October 30, 2024.
- **Marketing & Communications Update:** We remain committed to executing our strategic work plan.
  - I am pleased to share that the first annual report for GLAEF is expected to be released on November 7<sup>th</sup>. This is a milestone for the Foundation as we strive to provide a transparent and comprehensive overview of our achievements, financial health, and impact over the past year. As an accountability tool, the report will help build trust with donors, stakeholders, and the public by showcasing how funds are being utilized to support the mission. We look forward to sharing it with you.
  - Released the September 2024 newsletter featuring a fresh new design.
    - <https://mailchi.mp/095074c32c1c/your-monthly-glaef-news-exciting-updates-and-opportunities>
  - Issued two press releases
    - Inglewood Youth Education Fund (IYEF):  
<https://www.prnewswire.com/news-releases/greater-los-angeles-education-foundation-establishes-over-12-million-education->



[endowment-fund-supporting-youth-in-inglewood-california-302215492.html](https://www.glaef.org/_files/ugd/7cbd26_07780bb125864212b2f10939608a6da1.pdf)

- **Stitch:**  
[https://www.glaef.org/\\_files/ugd/7cbd26\\_07780bb125864212b2f10939608a6da1.pdf](https://www.glaef.org/_files/ugd/7cbd26_07780bb125864212b2f10939608a6da1.pdf)
  - Feature in two Articles
    - *Government Technology*  
Article: <https://www.govtech.com/education/k-12/6-more-teen-tech-centers-planned-for-los-angeles-county>
    - Antelope Valley Press  
[https://www.avpress.com/news/cutting-edge-technology-for-teens/article\\_14bfabc4-7d4d-11ef-8a2b-673e703f393f.html](https://www.avpress.com/news/cutting-edge-technology-for-teens/article_14bfabc4-7d4d-11ef-8a2b-673e703f393f.html)
  - Published a total of 26 posts across three key platforms—Instagram, X, and LinkedIn—expanding our reach and engagement across diverse audiences.
- **GLAEF Office Space Update:** I am pleased to provide an update on the significant progress we've made toward securing our new permanent office space. We have received a draft rendering (included). Blue Space Interiors will help us obtain a general contractor and architect to ensure appropriate project management. We are collecting final quotes and will be ready to move forward with the project and have set a completion target for this fiscal year. We are actively seeking funding opportunities to underwrite this project.
- **Upcoming event:**
  - Join Us for the Inaugural Los Angeles County State of Education Celebration on Thursday, November 7, 2024, at the Queen Mary in Long Beach.
  - GLAEF will be participating in Giving Tuesday this year. Details on how you can support will be forthcoming.



FURNITURE PLAN



bluespace  
INTERIORS

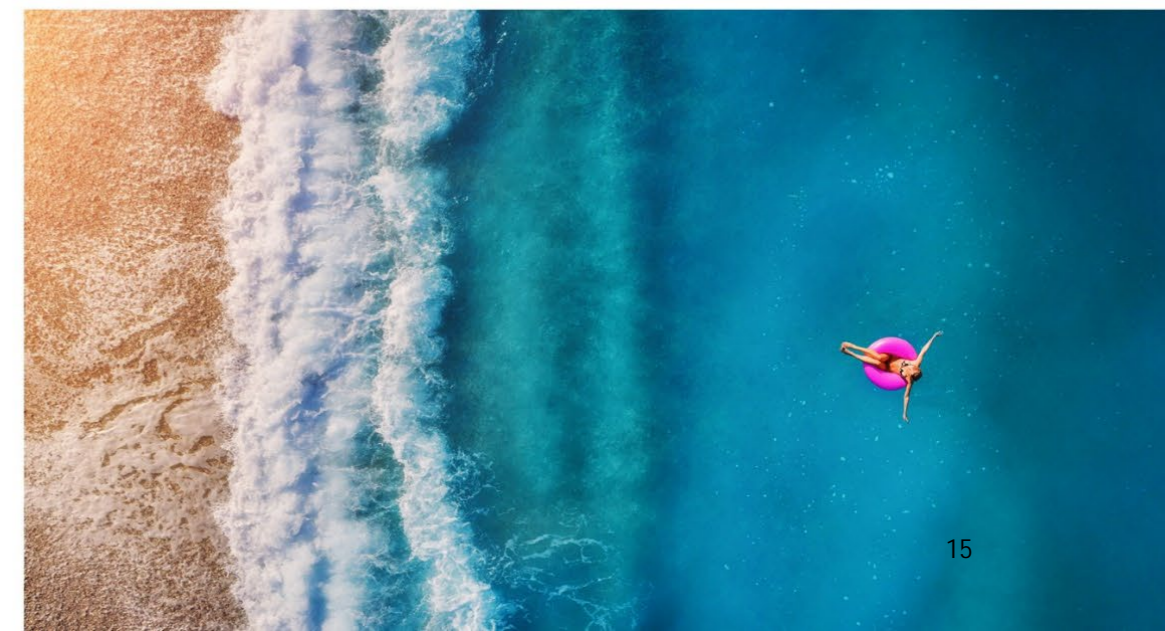

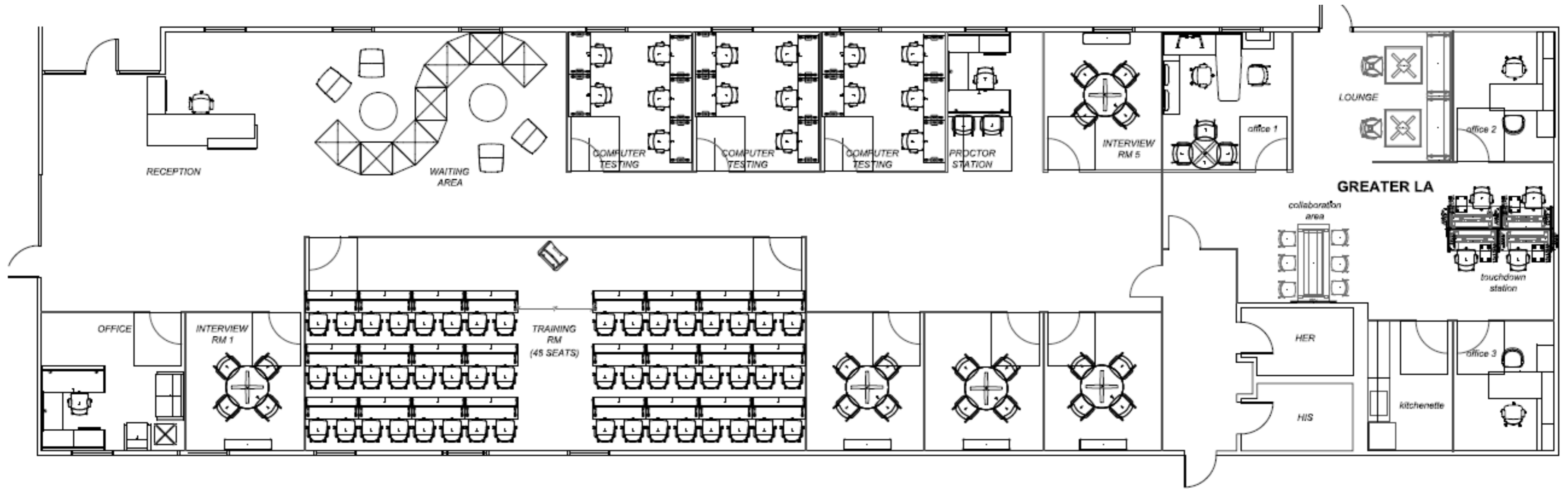

**OVERALL PLAN**

NOT TO SCALE



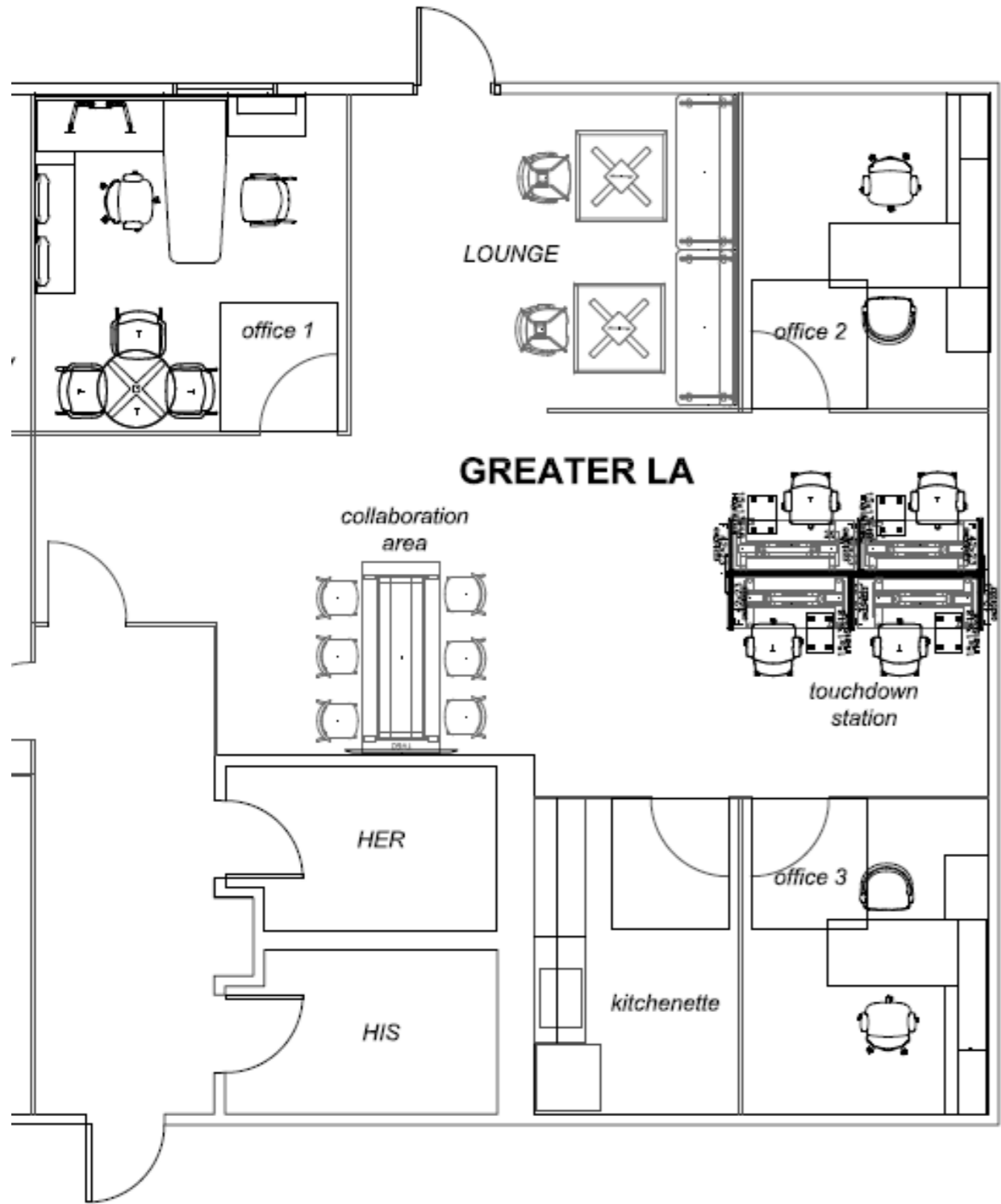

**GREATER LA SUITE**

NOT TO SCALE

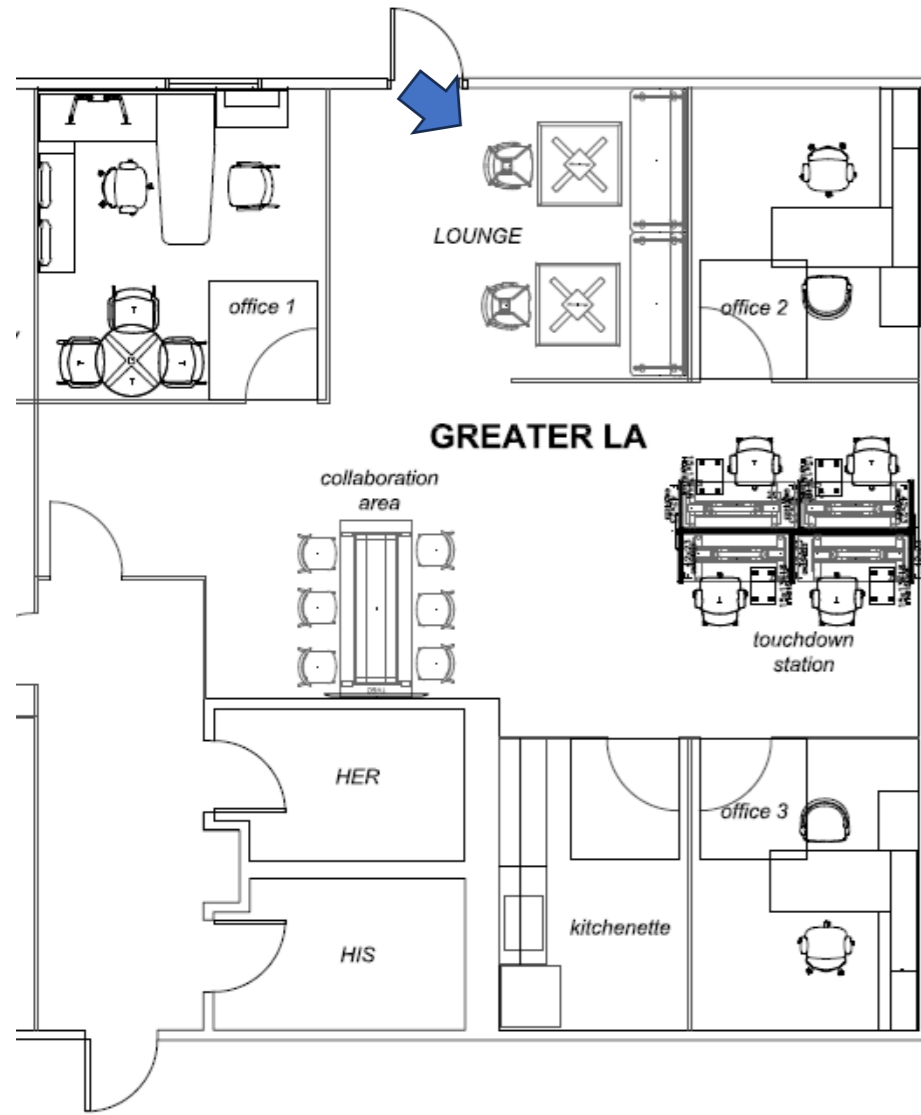

## GREATER LA SUITE

NOT TO SCALE

3/11

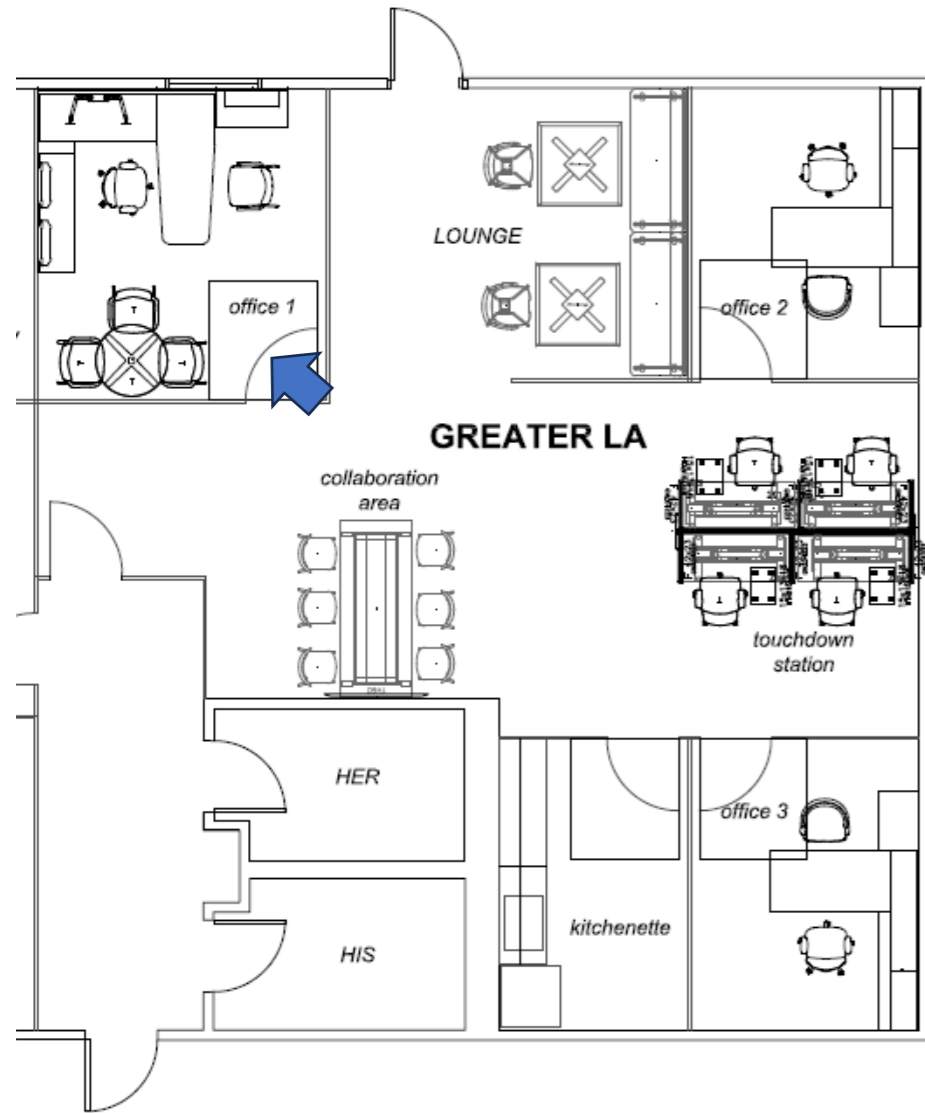

**GREATER LA SUITE**

NOT TO SCALE

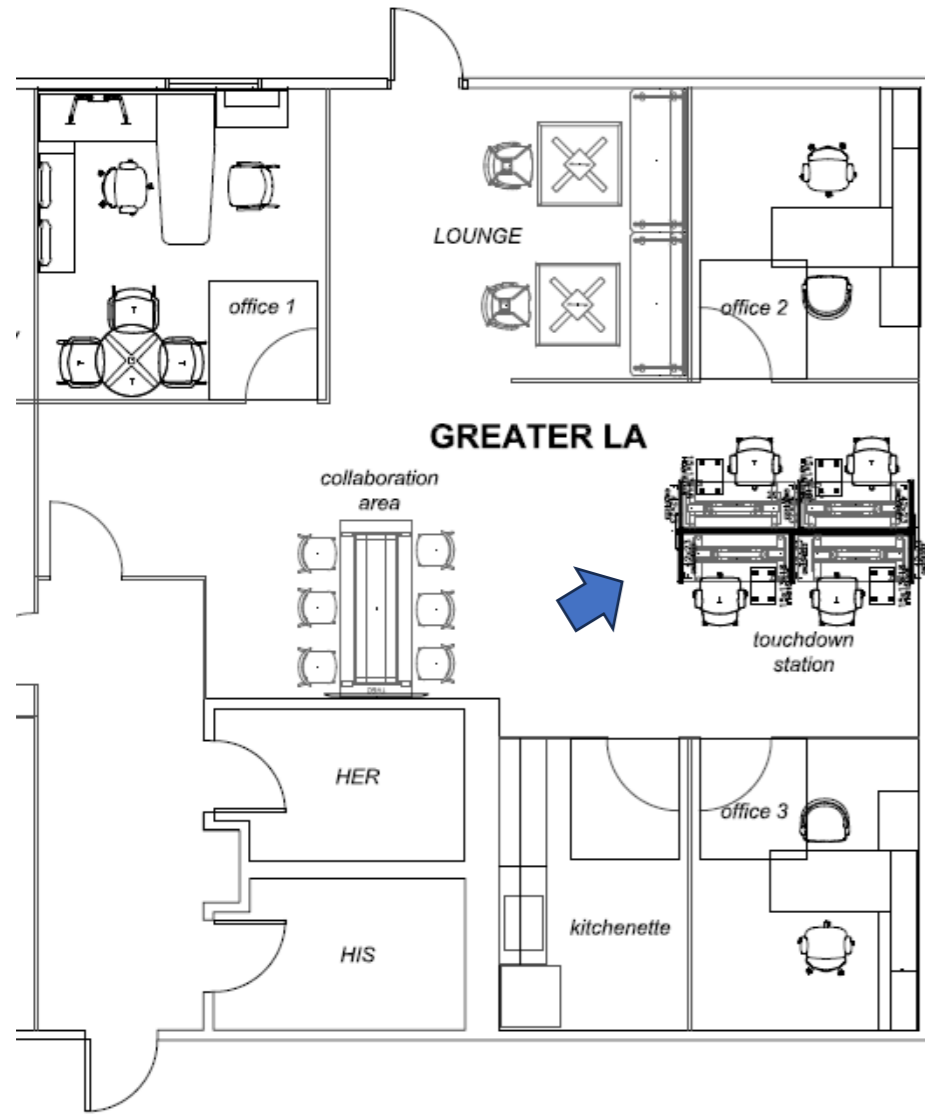

**GREATER LA SUITE**

NOT TO SCALE

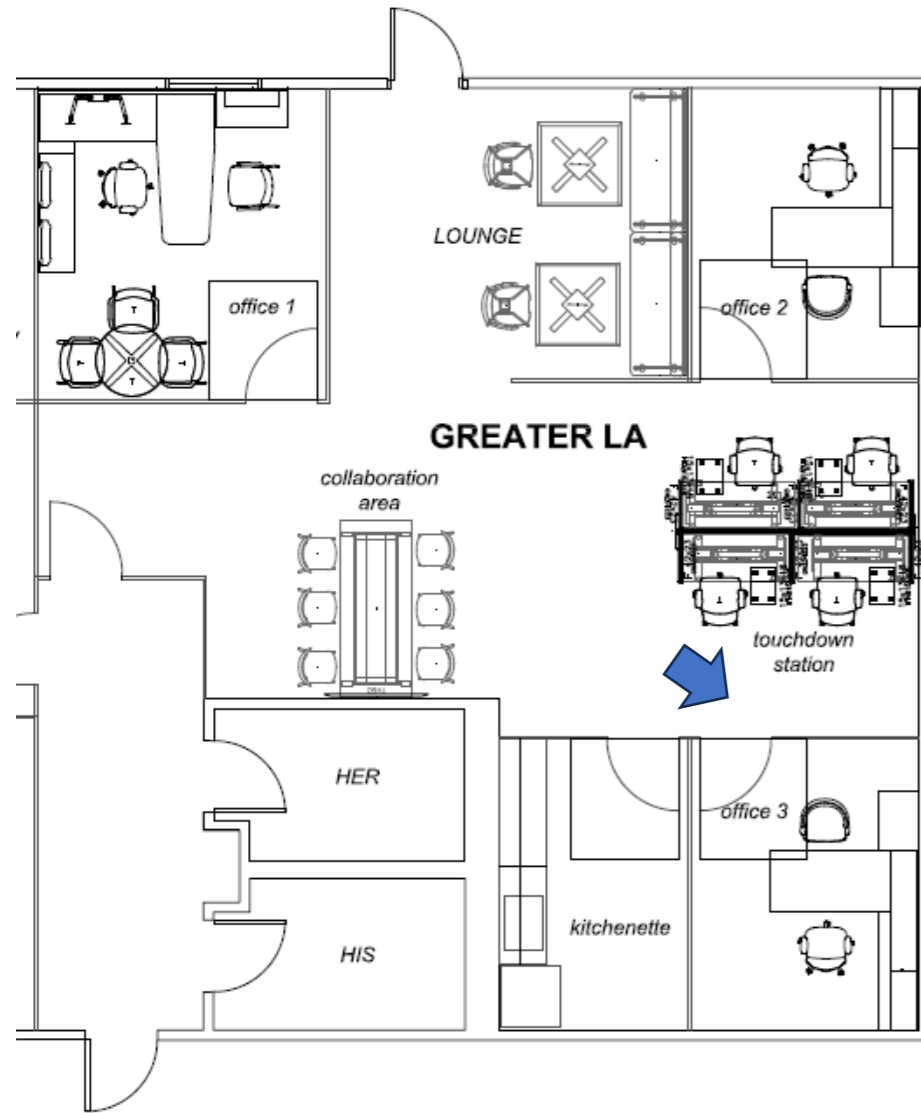

**GREATER LA SUITE**

NOT TO SCALE

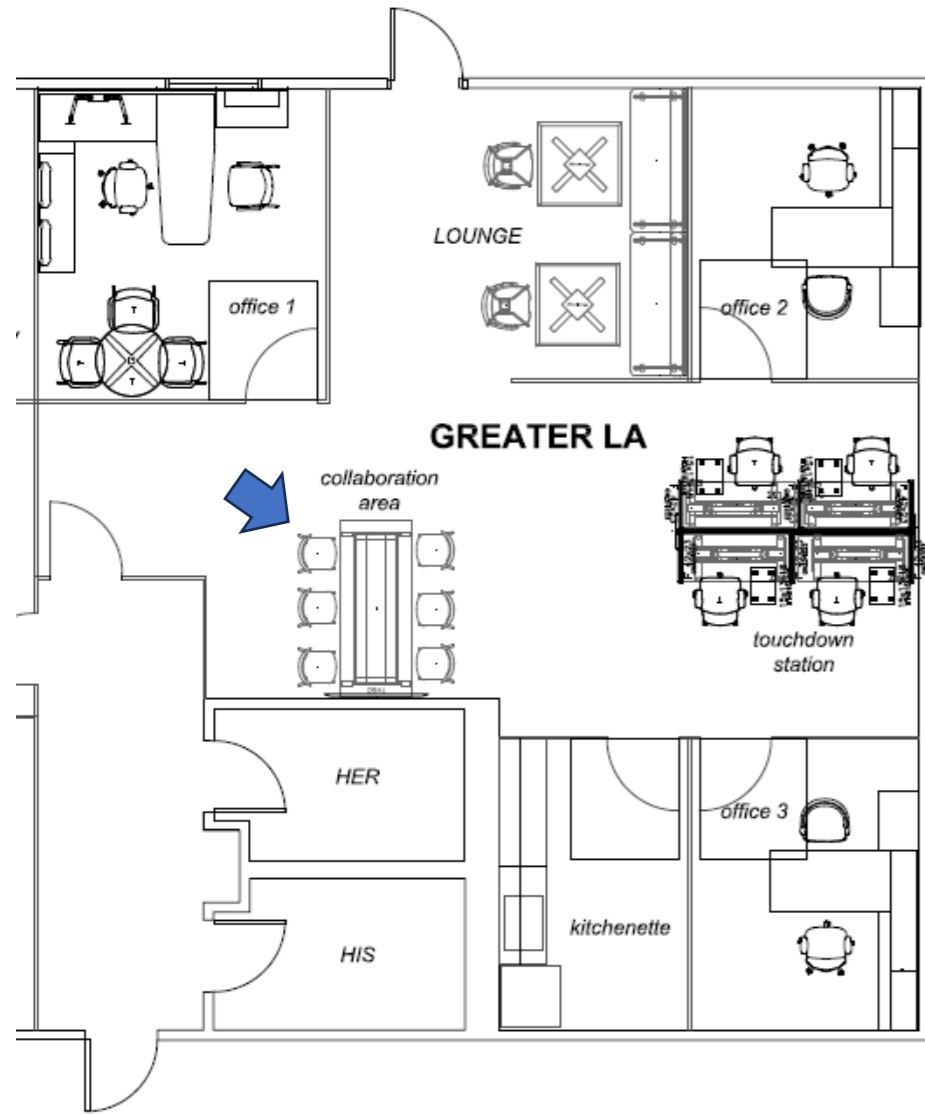

**GREATER LA SUITE**

NOT TO SCALE

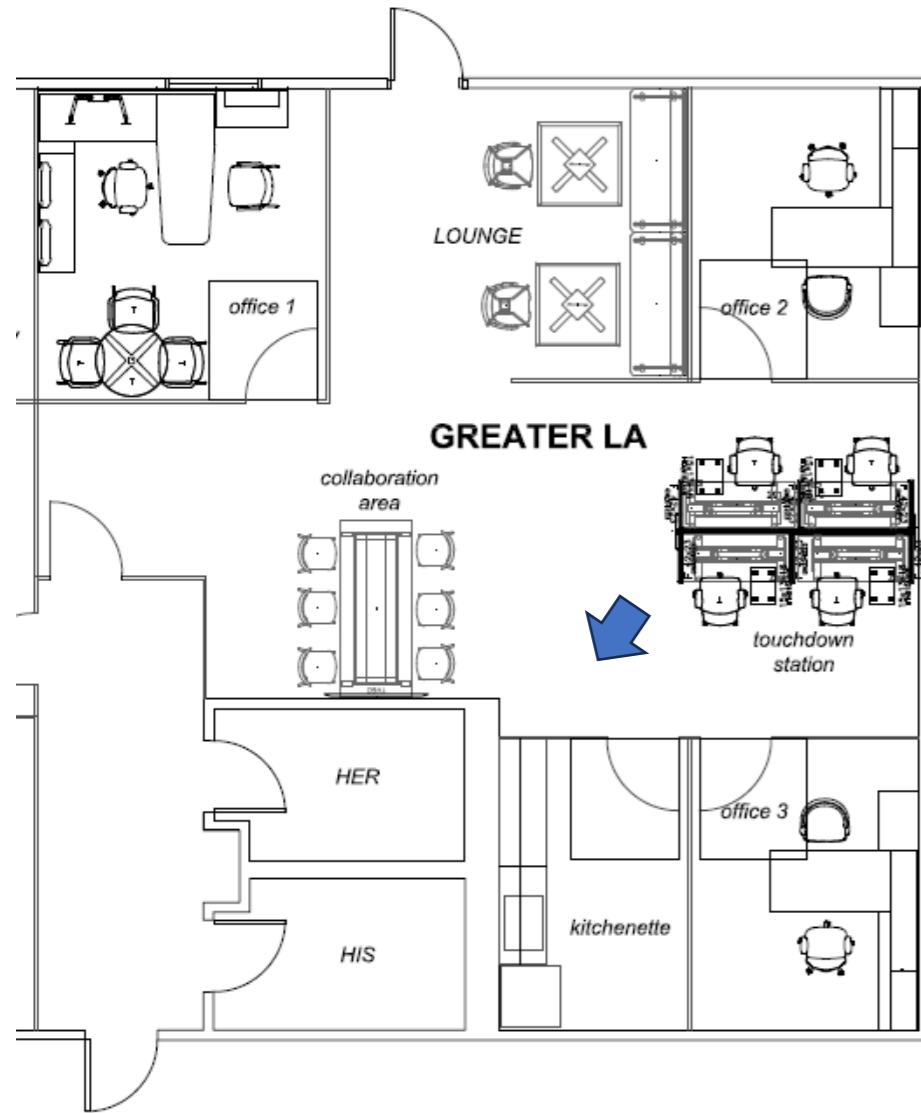

**GREATER LA SUITE**

NOT TO SCALE

**Greater Los Angeles Education Foundation**  
**Statement of Financial Position**  
As of June 30, 2024

	Jun 30, 2024	Jun 30, 2023	Change
<b>ASSETS</b>			
<b>Current Assets</b>			
Bank Accounts	537,726	4,916,993	(4,379,267)
Accounts Receivable	273,085	53,824	219,261
<b>Other Current Assets</b>			
1205 Interest and Dividends Receivable - GLAEF Cash Management	22,712		22,712
1210 Interest and Dividends Receivable - Inglewood Youth Education Fund	25,269		25,269
<b>Total Other Current Assets</b>	<b>47,981</b>	<b>-</b>	<b>47,981</b>
<b>Total Current Assets</b>	<b>858,793</b>	<b>4,970,817</b>	<b>(4,112,024)</b>
<b>Fixed Assets</b>	4,079	-	4,079
<b>Other Assets</b>			
1500 GLA Cash Management - Schwab Fixed Income x3471	5,997,535		5,997,535
1505 Inglewood Youth Education Fund - Schwab x3002	12,605,428		12,605,428
1600 Prepaid Expense	23,891	5,450	18,441
<b>Total Other Assets</b>	<b>18,626,853</b>	<b>5,450</b>	<b>18,621,403</b>
<b>TOTAL ASSETS</b>	<b>19,489,725</b>	<b>4,976,268</b>	<b>14,513,457</b>
<b>LIABILITIES AND EQUITY</b>			
<b>Liabilities</b>			
<b>Current Liabilities</b>			
Accounts Payable	282,641	9,193	273,448
<b>Other Current Liabilities</b>			
2110 Accrued Expenses	57,969	43,848	14,121
2120 Accrued Vacation	43,616	30,856	12,759
2260 Pass-through Grants Payable	2,000	-	2,000
<b>Total Other Current Liabilities</b>	<b>103,585</b>	<b>74,705</b>	<b>28,880</b>
<b>Total Current Liabilities</b>	<b>386,225</b>	<b>83,897</b>	<b>302,328</b>
<b>Total Liabilities</b>	<b>386,225</b>	<b>83,897</b>	<b>302,328</b>
<b>Equity</b>			
3120 Temporarily Restricted	3,965,647	3,965,647	-
3200 Unrestricted Net Assets	926,723	454,526	472,197
Net Revenue	14,211,129	472,197	13,738,932
<b>Total Equity</b>	<b>19,103,499</b>	<b>4,892,370</b>	<b>14,211,129</b>
<b>TOTAL LIABILITIES AND EQUITY</b>	<b>19,489,725</b>	<b>4,976,268</b>	<b>14,513,457</b>



**Greater Los Angeles Education Foundation**  
**Budget vs. Actuals**  
 July 2023 - June 2024

	Actual	Budget	Variance	% of Budget
<b>Revenue</b>				
4100 Restricted Contributions	16,789,031	2,502,150	14,286,881	670.98%
4200 Unrestricted Contributions	150,100	400,020	(249,920)	37.52%
4300 Admin Fees (Unrestricted)	60,921	267,017	(206,096)	22.82%
4700 Event Revenue	143,321	425,000	(281,679)	33.72%
4900 Inkind Contributions	12,832	20,000	(7,168)	64.16%
<b>Total Revenue</b>	<b>17,156,205</b>	<b>3,614,187</b>	<b>13,542,018</b>	<b>474.69%</b>
<b>Gross Profit</b>	<b>17,156,205</b>	<b>3,614,187</b>	<b>13,542,018</b>	<b>474.69%</b>
<b>Expenditures</b>				
5000 Salaries and Related Expenses	892,988	965,798	(72,811)	92.46%
5200 Inkind Expenses	12,832	20,000	(7,168)	64.16%
6010 Books & Publications	-	300	(300)	0.00%
6100 Grant Disbursements	890,810	940,000	(49,190)	94.77%
6280 Foundation Events	43,140	67,500	(24,360)	63.91%
6290 Event Sponsorship	215,195	375,000	(159,805)	57.39%
6300 Participant Incentives & Goodwill	74,654	95,600	(20,946)	78.09%
6410 Office Space	-	25,000	(25,000)	0.00%
6430 Office Supplies	28	8,000	(7,972)	0.35%
6550 Computers/Software	17,073	28,000	(10,927)	60.97%
7000 Contracted Services	478,913	541,500	(62,587)	88.44%
7110 Printing and Copying	2,591	22,500	(19,909)	11.52%
7120 Dues/Memberships/Subscriptions	10,299	10,000	299	102.99%
7130 Postage/Delivery	64	1,000	(936)	6.39%
7140 Telephone	5,400	7,500	(2,100)	72.00%
7150 Website	270	2,000	(1,730)	13.49%
7200 Professional Services	318,473	659,272	(340,799)	48.31%
7250 Marketing & Communication	116,213	3,000	113,213	3873.78%
7300 Conference/Meetings	117,783	404,250	(286,467)	29.14%
7400 Travel	4,906	15,000	(10,094)	32.71%
7600 Insurance	11,947	11,000	947	108.61%
7710 Registration, License & Permits	225	1,000	(775)	22.50%
7760 Bank Fees	825	1,500	(675)	54.97%
<b>Total Expenditures</b>	<b>3,214,628</b>	<b>4,204,720</b>	<b>(990,092)</b>	<b>76.45%</b>
<b>Net Operating Revenue</b>	<b>13,941,577</b>	<b>(590,533)</b>	<b>14,532,110</b>	<b>-2360.84%</b>
<b>Other Revenue</b>				
Investment Income			-	
Investment Income - GLA Cash Management	70,246			
Investment Income - Inglewood Youth Education Fund	199,447			
<b>Total Other Revenue</b>	<b>269,693</b>	<b>-</b>	<b>269,693</b>	
<b>Other Expenditures</b>				
8010 Depreciation	141		141	
<b>Total Other Expenditures</b>	<b>141</b>	<b>-</b>	<b>141</b>	
<b>Net Other Revenue</b>	<b>269,553</b>	<b>-</b>	<b>269,553</b>	
<b>Net Revenue</b>	<b>14,211,129</b>	<b>(590,533)</b>	<b>14,801,663</b>	<b>-2406.49%</b>

**The Greater LA Education Foundation**  
**Projected Cash Flow**  
FY25

<b>Beginning Cash and GLAEF Investment Balance 07/01/2024</b>	6,535,261
<b>Revenue</b>	
4100 Restricted Contributions	3,388,500
4200 Unrestricted Contributions	175,000
4300 Admin Fees (Unrestricted)	231,500
4700 Event Revenue	280,000
4900 Inkind Contributions	15,000
<b>Total Revenue</b>	<b>4,090,000</b>
<b>Gross Profit</b>	<b>4,090,000</b>
<b>Expenditures</b>	
5000 Salaries and Related Expenses	1,205,019
5200 Inkind Expenses	15,000
6010 Books & Publications	-
6100 Grant Disbursements	800,500
6280 Foundation Events	75,000
6290 Event Sponsorship	375,000
6300 Participant Incentives	98,000
6400 Office Equipment	12,000
6410 Office Space	38,000
6430 Office Supplies	2,500
6550 Computers/Software	25,000
7000 Contracted Services	262,000
7110 Printing and Copying	22,500
7120 Dues/Memberships/Subscriptions	12,000
7130 Postage/Delivery	2,500
7140 Telephone	8,400
7150 Website	4,000
7200 Professional Services	1,062,867
7250 Marketing & Communication	149,000
7275 Promotional Supplies	25,000
7300 Conference/ Meetings	376,500
7400 Travel	29,000
7600 Insurance	11,000
7710 Registration, License & Permits	500
7760 Bank Fees	1,500
<b>Total Expenditures</b>	<b>4,612,786</b>
<b>Net Use of Cash</b>	<b>(522,786)</b>
<b>Other Revenue</b>	
GLAEF Cash Management Investment Income	295,000
GLAEF Investment Management Fees	(16,000)
<b>Total Other Revenue</b>	<b>279,000</b>
<b>Net Revenue</b>	<b>(243,786)</b>
<b>Other Revenue</b>	
<b>Less Proposed Capital Expenditures (Leasehold Improvements)</b>	<b>(77,700)</b>
<b>Projected Ending Cash Balance 6/30/2024</b>	<b>6,213,775</b>



**Greater Los Angeles Education Foundation  
Recently Approved Projects**

Name of Project/Activity	EmbraceAbilities Grant Project
Project Affiliation within LA County (School District, etc.)	LACOE Division of SPED
Project’s Charitable Purpose	Project goal is to build capacity by providing support for systemic, continuous improvement to County Offices of Education (COE) and Local Educational Agencies (LEA) for the inclusion of students with extensive support needs.
Proposed Project Budget	Approximately 20K (provide support for 2-day EmbraceAbilities Learning Institute)
Date of Approval	10/2/24

Name of Project/Activity	Inglewood High School Marching Band Fundraising Campaign
Project Affiliation within LA County (School District, etc.)	Inglewood High School
Project’s Charitable Purpose	To raise funds to support IHS Marching Band performing in the 2025 National Independence Parade in Washington DC.
Proposed Project Budget	300K
Date of Approval	10/2/24

Name of Project/Activity	
Project Affiliation within LA County (School District, etc.)	
Project’s Charitable Purpose	
Proposed Project Budget	
Date of Approval	

Acceptance of Funds: July 1, 2023 through June 30, 2024		
Project	Funder	Amount
Inglewood Youth Education Fund	Anonymous	\$ 12,750,000.00
Dual Enrollment and Expanded Learning	The Eli and Edith Broad Foundation	\$ 1,460,000.00
Community Schools 2.0	Goldman Sachs	\$ 500,000.00
Developing LA County's Mandated Supporters	W.M Keck Foundation	\$ 475,000.00
EL-WIN 2024 grant	Philanthropic Ventures	\$ 214,062.50
General Support	Joseph Drown Foundation	\$ 150,000.00
Regional Practice and Policy Change in ELs	Sobrato Foundation	\$ 150,000.00
Mandated Reporter Initiative	Pritzker Foster Care Initiative	\$ 150,000.00
Arts and Music Grant	California Community Foundation	\$ 125,000.00
LASIF Antelope Valley Dual Enrollment	California Community Foundation	\$ 107,500.00
Art and Science Collide Initiative	Getty Foundation	\$ 100,000.00
General Support	Snap Foundation	\$ 50,000.00
Event Sponsorship	California Credit Union	\$ 40,000.00
John Calley Foundation	California Community Foundation	\$ 37,500.00
EL-WIN Planning and Coordination	Philanthropic Ventures	\$ 30,000.00
LACOE Signature Fund	Coast 2 Coast Coaching	\$ 25,800.00
LACOE Signature Fund	Arizona State University	\$ 25,000.00
Event Sponsorship	California Credit Union	\$ 14,000.00
LACOE Signature Fund	Innive Inc.	\$ 10,000.00
LACOE Signature Fund	TeachFX	\$ 10,000.00
MAS Unit Scholarships	Morgan Stanley	\$ 10,000.00
Event Sponsorship	California Credit Union	\$ 10,000.00
LACOE Signature Fund	Kooth USA Inc.	\$ 5,000.00
Alegria Scholarship Fund	Eric and Christine Alegria	\$ 4,750.00
Green Schools Symposium	Los Angeles County Office of Education	\$ 3,446.34
Classified School Employee Teacher Credentialing grant	Philanthropic Ventures	\$ 3,000.00
Superintendents Collaborative	Lakeshore Learning Materials	\$ 2,612.50
LACOE Signature Fund	clickandpledge - Lexia	\$ 2,612.50
LACOE Signature Fund	Universal Publishing	\$ 2,500.00
LACOE Signature Fund	Alder Graduate Schools of Education	\$ 2,500.00
Green Schools Symposium	Erickson-Hall Construction	\$ 2,000.00
Asian Pacific Heritage Fund	California Credit Union	\$ 1,500.00
Asian Pacific Heritage Fund	California Credit Union	\$ 1,500.00
Green Schools Symposium	Veregy Pacific	\$ 1,500.00
Green Schools Symposium	P2S Inc.	\$ 1,500.00
Green Schools Symposium	clickandpledge- HMC Architects	\$ 1,484.55
Green Schools Symposium	clickandpledge - KYA Group	\$ 1,484.55
Event Sponsorship	California Credit Union	\$ 1,265.00
LACOE Signature Fund	Little Bit of Learning	\$ 1,250.00
Migrant Education Scholarships	clickandpledge- Guadalupe Mendoza	\$ 1,001.92
Green Schools Symposium	Balfour Beatty	\$ 1,000.00
Asian Pacific Heritage Fund	Asian Pacific Heritage Group	\$ 814.25
LACOE Signature Fund	Charities Aid Foundation America	\$ 750.00
Migrant Education Scholarships	Miscellaneous Cash Donations	\$ 675.00
Migrant Education Scholarships	Miscellaneous Cash Donations	\$ 577.00
506 GAIN/Particip Support Serv.	LACOE Payroll Deductions	\$ 526.00
LACOE General Legacy Fund	clickandpledge-Chris Steinhauser	\$ 522.50
Grant Fund return	The Regents of the University of California	\$ 493.34
Asian Pacific Heritage Fund	clickandpledge - Christine Le	\$ 492.95
Green Schools Symposium	clickandpledge-Nichole Hough	\$ 471.60

**Greater LA Education Foundation  
Acceptance of Funds**

Back to Agenda

<b>Acceptance of Funds: July 1, 2023 through June 30, 2024</b>		
Project	Funder	Amount
Foster Youth Scholarship	clickandpledge - Ani Aharonian	\$ 471.60
201 Migrant Ed Scholarships	LACOE Payroll Deductions	\$ 450.00
Migrant Education Scholarships	Miscellaneous Cash Donations	\$ 278.00
LACOE General Legacy Fund	clickandpledge-Dr. Monte Perez	\$ 261.25
LACOE Signature Fund	clickandpledge-Kanika White	\$ 261.25
LACOE Signature Fund	clickandpledge - Karen Kimmel	\$ 250.00
LACOE Signature Fund	clickandpledge-Yvonne Chan	\$ 250.00
Wellbeing Fest Sponsorship	clickandpledge- Pamela Gibbs, Maricela Ramirez	\$ 242.34
Migrant Education Scholarships	Miscellaneous Cash Donations	\$ 200.10
203 African American Scholarships	LACOE Payroll Deductions	\$ 200.00
210 iPoly Student Scholarships	LACOE Payroll Deductions	\$ 200.00
109 Spelling Bee	LACOE Payroll Deductions	\$ 190.00
LACOE Signature Fund	clickandpledge - Eric Rowen	\$ 142.27
517 Outdoor/Marine Science	LACOE Payroll Deductions	\$ 130.00
Migrant Education Scholarships	clickandpledge - Astrid Gallon-Gonzelez, Dina Wilson	\$ 119.68
Migrant Education Scholarships	Miscellaneous Cash Donations	\$ 101.00
509 Special Ed Student Needs	LACOE Payroll Deductions	\$ 100.00
General Support	LACOE Payroll Deductions	\$ 100.00
LACOE Signature Fund	clickandpledge - Jose Gonzalez	\$ 100.00
Migrant Education Scholarships	clickandpledge- Victoria Conner	\$ 98.57
Migrant Education Scholarships	clickandpledge - Sonya Smith	\$ 92.04
Migrant Education Scholarships	Miscellaneous Cash Donations	\$ 78.00
LACOE Signature Fund	clickandpledge - Eric Rowen	\$ 50.00
Asian Pacific Heritage Fund	clickandpledge - Anonymous	\$ 44.72
Foster Youth Scholarship	clickandpledge- Melanie Buttarazzi	\$ 44.59
Migrant Education Scholarships	Miscellaneous Cash Donations	\$ 43.00
Foster Youth Scholarship	clickandpledge - Dana Christensen	\$ 35.11
MAS Unit Scholarships - Chuck Acosta	clickandpledge - Juan Ortiz	\$ 26.12
Foster Youth Scholarship	clickandpledge- Anonymous	\$ 25.62
Asian Pacific Heritage Fund	clickandpledge - Gabriella Watkins	\$ 21.94
Asian Pacific Heritage Fund	clickandpledge - Eric Rowen	\$ 16.21
Foster Youth Scholarship	clickandpledge- Florence Avognon	\$ 16.21
Foster Youth Scholarship	clickandpledge - Valencia Queen	\$ 16.13
Foster Youth Scholarship	clickandpledge - Melissa De La Cruz	\$ 16.13
Foster Youth Scholarship	clickandpledge - Armando Vilalpando	\$ 16.13
Migrant Education Scholarships	clickandpledge - Maria Moreno, Rosa Rodriguez	\$ 7.50
	<b>Total</b>	<b>\$ 16,495,788.01</b>

**Greater Los Angeles Education Foundation  
Inglewood Youth Education Fund  
Statement of Activity  
March 14, 2024 - June 30, 2024**

<b>Revenue</b>	
<b>4100 Restricted Contributions</b>	12,750,000
<b>4300 Administrative Fees<sup>1</sup></b>	(318,750)
<b>Total Revenue</b>	<u>12,431,250</u>
<b>Gross Profit</b>	<b>12,431,250</b>
<b>Expenditures</b>	
<b>Total Expenditures</b>	
<b>Net Operating Revenue</b>	<u>12,431,250</u>
<b>Other Revenue</b>	
<b>Investment Income</b>	
<b>Investment Income - Inglewood Youth Education Fund</b>	
<b>4997 Unrealized Gain/Loss - Inglewood Youth Education Fund</b>	128,768
<b>4998 Dividends - Inglewood Youth Education Fund</b>	55,128
<b>4999 Interest - Inglewood Youth Education Fund</b>	31,151
<b>7770 Investment Management Fees - Inglewood Youth Education Fund</b>	(15,600)
<b>Total Investment Income - Inglewood Youth Education Fund</b>	<u>199,447</u>
<b>Total Investment Income</b>	<u>199,447</u>
<b>Total Other Revenue</b>	<u>199,447</u>
<b>Net Other Revenue</b>	<u>199,447</u>
<b>Net Revenue</b>	<u>12,630,697</u>

<sup>1</sup>In accordance with the budget submitted by GLAEF to the Funder, a 2.5% administrative fee of \$12.75M (\$318,750) was taken upon initial receipt of funds. Thereafter, GLAEF will recognize a 1.75% annual administrative fee of the investment balance net of any investment management fees. This fee will be recognized on a quarterly basis. For Q3, GLAEF will recognize administrative fee revenue of \$3,338.27. For Q4, GLAEF will recognize administrative fee revenue of \$40,678.92.

## **Funding Recommendations for Inglewood Youth Education Fund** *Fall of 2024*

The Inglewood Youth Education Fund (IYEF) at the Greater Los Angeles Education Foundation (GLAEF) was established to benefit youth living in Inglewood, California, by providing resources to nonprofit organizations and initiatives that address the educational needs of Inglewood youth.

GLAEF aims to announce the initial cohort of IYEF grantees by October 11, 2024. The formal grantmaking program will be announced in early 2025, and the inaugural grantmaking cycle will commence in the Fall of 2025.

### **Funding Recommendation**

GLAEF is pleased to recommend the initial cohort, which will receive a total investment of \$150,000 across 12 organizations; two partners will receive grants of \$25,000, and ten will receive \$10,000. Funding will be awarded as general operating support when possible. Funding for district and school partners will support aligned programs, which will be determined with appropriate guidance from the grantee.

Awarding an initial cohort of grantees before the formal grantmaking program is announced will allow the IYEF to engage organizations serving the Inglewood committee, invest in vital non-profit service infrastructure, ensure that all focus areas are addressed, and foster foundational relationships with organizations that will be key partners for years to come.

### **Discovery and Data Collection**

Starting in the winter of 2024, GLAEF has conducted informational interviews with regional education leaders, city leadership, and policymakers. Four strategic listening sessions were conducted in July and August of 2024 with community organizations serving Inglewood students, funders, parents, and community advocates. This initial discovery and landscape analysis spotlighted dozens of organizations operating in Inglewood and provided key strategic insights into the kinds of programs and service providers that can be most effective.

Following the completion of the listening sessions, GLAEF developed and disseminated a ‘Service Inquiry’ questionnaire to collect and organize information on various agencies and service providers. Organizations identified through the discovery phase were asked to complete the questionnaire and identify trusted and effective local partners serving the region. These organizations were also invited to complete the questionnaire. The questionnaire was distributed directly by GLAEF, listed on the GLAEF website, and shared by the Clippers Foundation following a community presentation that featured information on the IYEF.

## **Strategic Analysis**

GLAEF developed a rubric to analyze the organizations that submitted information. The rubric integrated necessary conditions for IYEF's grantmaking framework and served as a guide for analyzing responses that incorporated priorities elevated during the listening sessions.

The rubric initially filtered organizations according to key criteria: that they are eligible recipients (e.g., a school or district, non-profit, or faith-based organization) and are currently serving students in Inglewood. Additional criteria included strategies for community engagement, how youth voice is centered in programs, existing partnerships in Inglewood (for example, with schools or partner agencies), and available resources to provide services in Inglewood. Organizations that were highlighted by peers received additional points.

GLAEF received 32 completed questionnaires. Using a scoring rubric based on the provided information, GLAEF identified 12 organizations that achieved exemplary scores or were deemed excellent candidates for grantmaking. These organizations include traditional non-profits, charter schools, and the Inglewood Unified School District. Prospective grantees offer services across the five focus areas (After-school tutoring, Youth Innovation and STEM Design Camps, Keeping Students in School, Opening Pathways to College, and College Scholarships) and offer a range of operating capacity, size, and history. All demonstrate a deep commitment to Inglewood's students.

## **Grantmaking Recommendations**

GLAEF proposed awards totaling \$150,000 to the following organizations:

### **\$25,000 Awardees**

1. Social Justice Learning Institute
2. Inglewood Unified School District

### **\$10,000 Awardees**

3. Engineer Factory, a Project of Community Partners
4. Pass It Forward Foundation
5. We Grow Inglewood
6. Heads Up Foundation, Inc.
7. Our Own
8. SoLA Robotics
9. I'm A Movement Not A Monument
10. Environmental Charter Schools (ECS)
11. Urban Scholar Academy
12. Brotherhood Crusade



<b>Organization</b>	<b>Mission</b>	<b>Budget</b>	<b>Focus Areas</b>
<p>Social Justice Learning Institute</p> <p>Derek Steele, Executive Director</p>	<p>The Social Justice Learning Institute (SJLI) is dedicated to improving the education, health, and well-being of youth and communities of color by empowering them to enact social change through research, training, and community mobilization.</p>	\$8,002,842	<ul style="list-style-type: none"> <li>• Keeping Students in School</li> <li>• Opening Pathways to College</li> <li>• College Scholarships</li> </ul>
<p>Inglewood Unified School District</p> <p>James Morris, County Administrator</p>	<p>IUSD's mission is to nurture, educate, and graduate students who are self-responsible and self-disciplined; who are critical and creative thinkers; who master the core academic disciplines; and who are advocates for equity and social justice for self and their community.</p>	\$200,000,000	<ul style="list-style-type: none"> <li>• After-School Tutoring</li> <li>• Youth Innovation and STEM Design Enrichment</li> <li>• Keeping Students in School</li> <li>• Opening Pathways to College</li> </ul>
<p>Engineer Factory, a Project of Community Partners</p> <p>Audrey Thompson, Founder &amp; Executive Director</p>	<p>Strengthen the K-12 STEM (science, technology, engineering, and math) education pipeline and increase the number of students from underrepresented populations (girls and BIPOC) who pursue higher education and careers in Engineering and STEM.</p>	\$410,000	<ul style="list-style-type: none"> <li>• Youth Innovation and STEM Design Enrichment</li> <li>• Opening Pathways to College</li> </ul>
<p>Pass It Forward Foundation</p> <p>La Tijera Avery, Executive Director</p>	<p>Fuel the spark within youth by empowering them through holistic health, transformative education, and exhilarating sports programs.</p>	\$285,910	<ul style="list-style-type: none"> <li>• Youth Innovation and STEM Design Enrichment</li> <li>• Opening Pathways to College</li> <li>• College Scholarships</li> </ul>
<p>We Grow Inglewood</p> <p>Lauren Brazile, President</p>	<p>Dedicated to nurturing the potential of our Inglewood communities. Through food and resource distribution, extracurricular school programming, safe space events, and one-on-one mentorship, we empower local communities to thrive, equipping families and businesses with tools to become the future leaders of a vibrant, inclusive, and prosperous city of champions.</p>	\$102,000	<ul style="list-style-type: none"> <li>• After-School Tutoring</li> <li>• Keeping Students in School</li> <li>• Opening Pathways to College</li> </ul>

<b>Organization</b>	<b>Mission</b>	<b>Budget</b>	<b>Focus Areas</b>
<p>Heads Up Foundation, Inc.</p> <p>Subrina Miller, Executive Director</p>	<p>Offer educational support and promote community awareness to families in Inglewood and surrounding areas, with a focus on at-risk and foster youth.</p>	\$40,000	<ul style="list-style-type: none"> <li>• Opening Pathways to College</li> </ul>
<p>Our Own</p> <p>Dustin Young, Founder</p>	<p>Dismantle systemic barriers across mental health &amp; wellness, STEAM education, entrepreneurship, physical fitness, and spatial equity. They strive to foster access and bridge existing gaps in these critical areas, promoting inclusivity and opportunity for our communities.</p>	\$1,200,000	<ul style="list-style-type: none"> <li>• Keeping Students in School</li> <li>• Opening Pathways to College</li> <li>• Youth Innovation and STEM Design Enrichment</li> </ul>
<p>SoLA Robotics</p> <p>Jennifer Lashley, Executive Director</p>	<p>Bridge the gap in technology access and education, inspiring students to pursue STEM careers while preparing them with the skills necessary for success in a rapidly changing world.</p>	\$350,000	<ul style="list-style-type: none"> <li>• Youth Innovation and STEM Design Enrichment</li> <li>• Opening Pathways to College</li> </ul>
<p>I'm A Movement Not A Monument</p> <p>Duran Bowie, Executive Director</p>	<p>Aims to empower today's youth. It provides mentoring and youth development programs designed to build core values and strengthen academic and life skills. I'm a Movement Not a Monument strives to encourage children and teenagers to achieve their dreams and become great leaders.</p>	\$225,000	<ul style="list-style-type: none"> <li>• After-School Tutoring</li> <li>• Youth Innovation and STEM Design Enrichment</li> <li>• Keeping Students in School</li> <li>• Opening Pathways to College</li> </ul>
<p>Environmental Charter Schools (ECS)</p> <p>Farnaz Golshani Flechner, Superintendent</p>	<p>Reimagine public education in low-income communities of color to prepare conscious, critical thinkers who are equipped to graduate from college and create a more equitable and sustainable world.</p>		<ul style="list-style-type: none"> <li>• Youth Innovation and STEM Design Enrichment</li> <li>• Keeping Students in School</li> </ul>
<p>Urban Scholar Academy</p> <p>Alexis Coleman, Executive Director</p>	<p>Transform the lives of K-12th grade South Los Angeles youth through academic enrichment and community service opportunities. Our core belief is that every child, regardless of their socio-economic background, deserves an after-school learning environment that celebrates their identity and promotes academic rigor.</p>	\$589,000	<ul style="list-style-type: none"> <li>• After-School Tutoring</li> <li>• Youth Innovation and STEM Design Enrichment</li> <li>• Opening Pathways to College</li> </ul>

<b>Organization</b>	<b>Mission</b>	<b>Budget</b>	<b>Focus Areas</b>
<p>Brotherhood Crusade</p> <p>Charisse Bremond Weaver, President and CEO</p>	<p>Champion equality and equity by removing and/or helping individuals overcome the barriers that deter their pursuit of success in life and facilitate opportunities for a better quality of life by effectuating improved health &amp; wellness, facilitating academic success, promoting social &amp; economic growth, providing access to artistic excellence &amp; cultural awareness, increasing financial literacy, and supporting community agencies.</p>	<p>\$12,000,000</p>	<ul style="list-style-type: none"> <li>• Keeping Students in School</li> <li>• Opening Pathways to College</li> <li>• College Scholarships</li> </ul>



**GREATER LOS ANGELES  
EDUCATION FOUNDATION**

**PROGRAM UPDATE**  
October 30, 2024



1

# INGLEWOOD YOUTH EDUCATION FUND

- \$12.75M fund dedicated to support youth in Inglewood
  - Tutoring, College Access, Design and Innovation, Chronic Absenteeism, Scholarships
- Landscaping and community engagement:
  - Interviews with LACOE leadership
  - City and County representatives
  - Strategic listening sessions: non-profits, funders, residents, educators, parents
  - Presentation at Clippers partner convening with 150+ attendees
- Service Inquiry Form
  - 32 organizations identified







    @greaterlaedfund

2

# INGLEWOOD YOUTH EDUCATION FUND



Organization	Award Amount	Focus Areas
Social Justice Learning Institute	\$25K	Keeping Students in School • Opening Pathways to College • College Scholarships
Inglewood Unified School District	\$25K	After-School Tutoring • Youth Innovation and STEM Design Enrichment • Keeping Students in School • Opening Pathways to College
Engineer Factory, a Project of Community Partners	\$10K	Youth Innovation and STEM Design Enrichment • Opening Pathways to College
Pass It Forward Foundation	\$10K	Youth Innovation and STEM Design Enrichment • Opening Pathways to College • College Scholarships
We Grow Inglewood	\$10K	After-School Tutoring • Keeping Students in School • Opening Pathways to College
Heads Up Foundation, Inc.	\$10K	Opening Pathways to College
Our Own	\$10K	Keeping Students in School • Opening Pathways to College • Youth Innovation and STEM Design Enrichment
SoLA Robotics	\$10K	Youth Innovation and STEM Design Enrichment • Opening Pathways to College
I'm A Movement Not A Monument	\$10K	After-School Tutoring • Youth Innovation and STEM Design Enrichment • Keeping Students in School • Opening Pathways to College
Environmental Charter Schools (ECS)	\$10K	Youth Innovation and STEM Design Enrichment • Keeping Students in School
Urban Scholar Academy	\$10K	After-School Tutoring • Youth Innovation and STEM Design Enrichment • Opening Pathways to College
Brotherhood Crusade	\$10K	Keeping Students in School • Opening Pathways to College • College Scholarships









 @greaterlaedfund

3

# MANDATED SUPPORTER TRAINING



- Pilot training with select districts in 2024/25
  - Grant writing support, basic needs grants
- Finalizing supplemental educator module
  - UCLA Prevention Center of Excellence
- Centering Students and Families: Mandated Reporting Reform in LA County Schools
  - Build awareness, foster engagement, inspire action
  - October 21 at Almansor Court
  - 40+ Districts and 150 district administrators





 @greaterlaedfund

4

# TEEN TECH CENTERS



- All five ARP-funded Teen Tech Centers will be open by the end of 2025
  - Boys and Girls Club Metro LA at Watts/Willowbrook: first week of November
  - Weingart East LA YMCA: mid-December
  - Long Beach YMCA: Grand Opening event on January 27
  - Antelope Valley had their Grand Opening event on September 26
- 450 unique students have utilized the new Tech Centers since opening
- Administered \$930,117.74 of ARP funds (nearly half of \$2m allocated)
- Finalizing the agreement with Probation to open a Teen Tech Center at Barry J. Nidorf
- 3 more sites to open in 2025: El Monte, Southeast LA, Compton



@greaterlaedfund

5

# YOUNG INNOVATORS ACCELERATOR



- Young Innovators Accelerator kicked off year 2 in September
- Doubled impact this year to include 6 Teen Tech Centers:
  - Bresee, Legacy LA, VSEDC, NVCS, Antelope Valley, Long Beach at Carmelitos
  - 60 students participating/21 teams pitching
- Contracted with the Los Angeles Economic Equity Accelerator & Fellowship (LEEAF) to provide training and program implementation
- Semi-finals pitch at each TTC in November; top pitches will compete at the Final Pitch
- Final Pitch Competition at Spotify HQ on December 5



@greaterlaedfund

6

## COLLEGE & CAREER ACCESS



- GLAEF is investing in LACOE's capacity to expand dual enrollment
  - LACOE's CTE team has hired 2 staff members dedicated to DE
- In August, GLAEF and LACOE's data team presented at CTE's GSPP Launch event
- Working in alignment with LARC, Career Ladders, other program partners
  
- CTE will hold four in-person dual enrollment training sessions
  - 11/7: Equity Goals and Reporting, Program Integrity and Credit Transfer
    - Registration exceeded capacity; LACOE will offer a morning and afternoon session
    - 50 participants from 22 K12 districts: counselors, admins, teachers, CTE Pathways coordinators
  - 12/11: Finance, Course Access and Availability
  - 4/2: Instructor Capacity, Navigational Supports
  - 5/14: Celebration of Model Programs







 @greaterlaedfund

7

## ENGLISH LEARNER WORKFORCE INVESTMENT NETWORK (EL-WIN)



- Contracting with TNTP to lead the EL-WIN LA County project
- TNTP will work closely with GLAEF, MAS and Head Start to build sustainable district and IHE partnerships that will create a workforce pipeline for UPK/TK educators who can serve MLLs
  - Nov.-Jan.: Landscape analysis
  - Jan.-Mar.: Strategic Planning
  - Mar.-Dec.: Implement with regional hub leaders and LACOE, CoPs, Fundraising trainings









 @greaterlaedfund

8

# STITCH & PST ART

- Stitch has officially launched and is the most viewed page on the GLAEF website!
- Stitch currently features over a 1,000 unique programs
- Promotion
  - The coalition is collectively promoting stitch at various network events, like Expand LA's Lights On Afterschool Press Conference.
  - GLAEF is hosting a 4-part PST ART educator webinar series throughout 2024/25.

Visit Stitch: [www.glaef.org/stitch](http://www.glaef.org/stitch)

 @greaterlaedfund

9

# EXPANDED LEARNING & ENRICHMENT COMMUNITY OF PRACTICE (E&E COP)



- Aimed to expand HS enrichment and expanded learning programs in LA County, this program will include funding, 1:1 Coaching, CoP and strategic storytelling.
- The culminating storytelling will spotlight the new programs from CoP participants and illuminate the commitment of CA and LA County to support OST programs for youth.
- Partners & Participants
  - GLAEF is partnering with LACOE's ELTAU and Education First.
  - GLAEF has selected five school sites. Ranging in school size, charter vs traditional LEA and types of proposed program designs.
- Next steps:
  - Grant Agreements are going out, interviews with OST experts for storytelling are beginning and the CoP will kick off on January 23, 2025.



 @greaterlaedfund

10



## MULTILINGUAL RESEARCH



- GLAEF is partnering with **LACOE's MAS Unit** and **Stanford's CSET** for our latest white paper. It focuses on secondary teachers' experiences serving EL/MLL students in LA County.
- Currently finalizing the 2nd draft and preparing to start the design process.
- The white paper is will be finalized this Fall.
- GLAEF is excited to partner with LACOE Communications for new and engaging promotion strategies.



    @greaterlaedfund

11

## COMMUNITY SCHOOLS INITIATIVE



- LACOE CSI: 21 schools serving 27,094 students
- Regional Technical Assistance: Providing technical assistance, coaching and support to 302 schools serving 309,620 students
  - GLAEF is sponsoring site level grants, convenings and meetings, strategic communications, and evaluation
- Looking ahead:
  - Transformation Zones
  - Sustainability
  - Evaluation
- Partner Engagement
  - Site visit with Ballmer Group
  - January visit with Steve and Connie Ballmer

    @greaterlaedfund

12

# GREEN SCHOOLS & SUSTAINABILITY



- Partnering with Green Schools National Network
  - Developing Sustainability Plan
  - Baseline report
  - Five Year Sustainability Plan
    - Leadership
    - Curriculum and Instruction
    - Culture and Climate
    - Facilities and Operation



@greaterlaedfund

# UPCOMING EVENTS



## November 2024

- Nov. 7-8: LA County State of Education & Superintendents' Collaborative
- Nov. 7: LACOE CTE Dual Enrollment Training I
- Nov. 20: PST ART Educator Webinar

## December 2024

- Dec. 5: YIA Final Pitch Competition
- Dec. 11: LACOE CTE Dual Enrollment Training II

## January 2025

- Jan. 15: PST ART Educator Webinar
- Jan. 23: GLAEF E&E CoP Kick Off
- Jan. 27: Teen Tech Center at Carmelitos (Long Beach) Grand Opening

## February 2025

- Feb. 26: PST ART Educator Webinar
- Feb. 28: LACOE Women's Leadership & Empowerment Conference

@greaterlaedfund

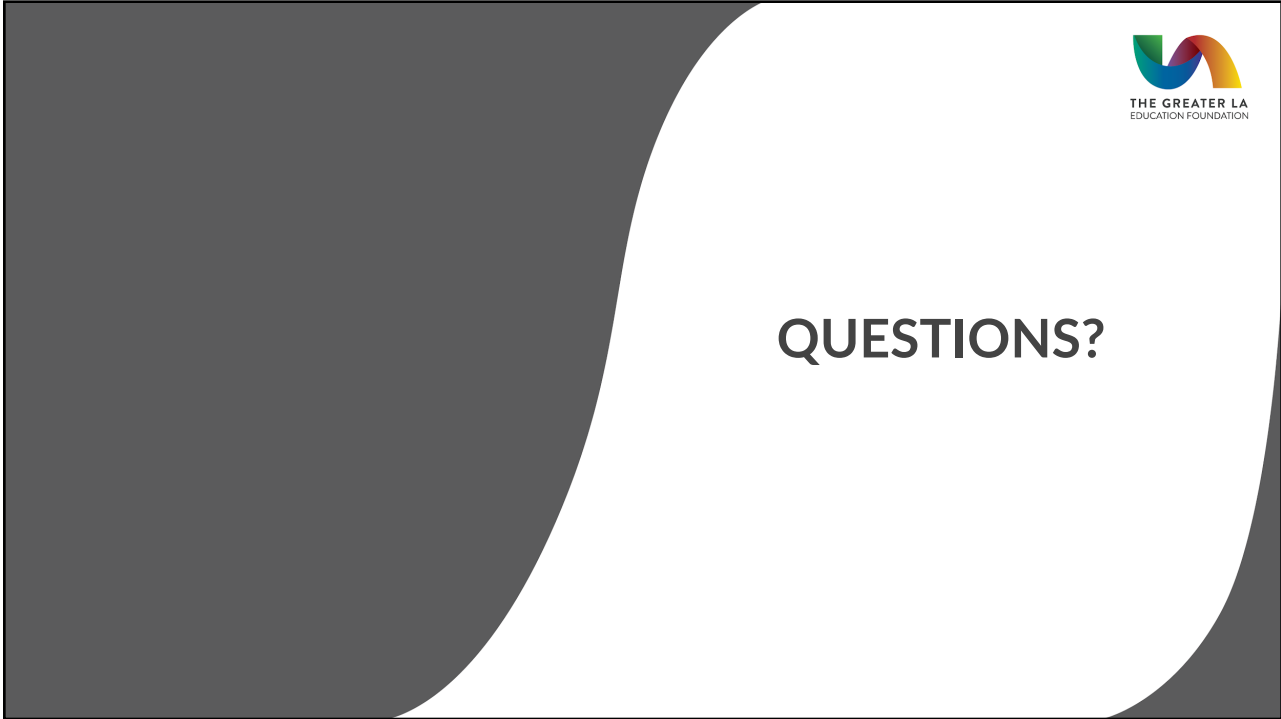



## Board of Directors Meeting Calendar 2024-2025

MEETING	DAY	DATE	TIME	LOCATION
BOARD OF DIRECTORS	Wednesday	October 30, 2024	2:00 pm - 4:00 pm	LACOE Board Room, 9300 Imperial Hwy, Downey 90242
ANNUAL MEETING	Wednesday	January 15, 2025	1:00 pm - 5:00 pm	TBD
BOARD OF DIRECTORS	Wednesday	April 23, 2025	2:00 pm - 4:00 pm	LACOE Board Room, 9300 Imperial Hwy, Downey 90242
BOARD OF DIRECTORS	Wednesday	June 25, 2025	2:00 pm - 4:00 pm	LACOE, 9300 Imperial Hwy, Downey 90242